

# Conservation Tract Legend

## AGRICULTURAL OPEN SPACE

### Pasturelands

Livestock and wildlife habitat. (In all areas outside of stream and riparian corridors)

## WILDLIFE HABITAT

### Protected Habitat For Sensitive Species

#### Bald Eagle Nest

Primary nest area (Zone A) - zone of no disturbance: 0-1/4 miles  
Primary use area (Zone B) - zone of limited disturbance: 1/4-1/2 miles

#### Great Blue Heron Rookery

Zone A - Zone of no disturbance: 541 foot radius  
Zone B - Zone of limited disturbance: 984 foot radius

### Stream And Riparian Restoration

Restoration of spring-fed streams, riparian areas and wetlands for cold water fisheries, amphibians, shorebirds and wildlife

### Big Game Winter Range

Site specific "Critical" elk winter range  
2002 elk winter range - Idaho Department of Fish and Game

### Big Wood River Riparian Enhancement

Cottonwood forest regeneration and protection

## RECREATION

### Public Fisherman's Easement

25 foot fisherman's easement off the ordinary high water mark of the Big Wood River for public fishing access, via Stamm Crossing.

### Improved Trails

Pedestrian trails for use by ranch property owners.

Equestrian trails for use by equestrian members and ranch property owners.

## INTERPRETIVE CENTER

An Interpretive Center for the use, enjoyment, and education of the public to learn about the settlement of the Wood River Valley; the history of the cattle ranching on the Ranch; the restoration of the Big Wood Corridor and spring-fed creeks; and how a working cattle ranch and wildlife preserve operate together.

## HISTORIC PRESERVATION

The preservation and mitigation of structures, open space, and land with local historic importance

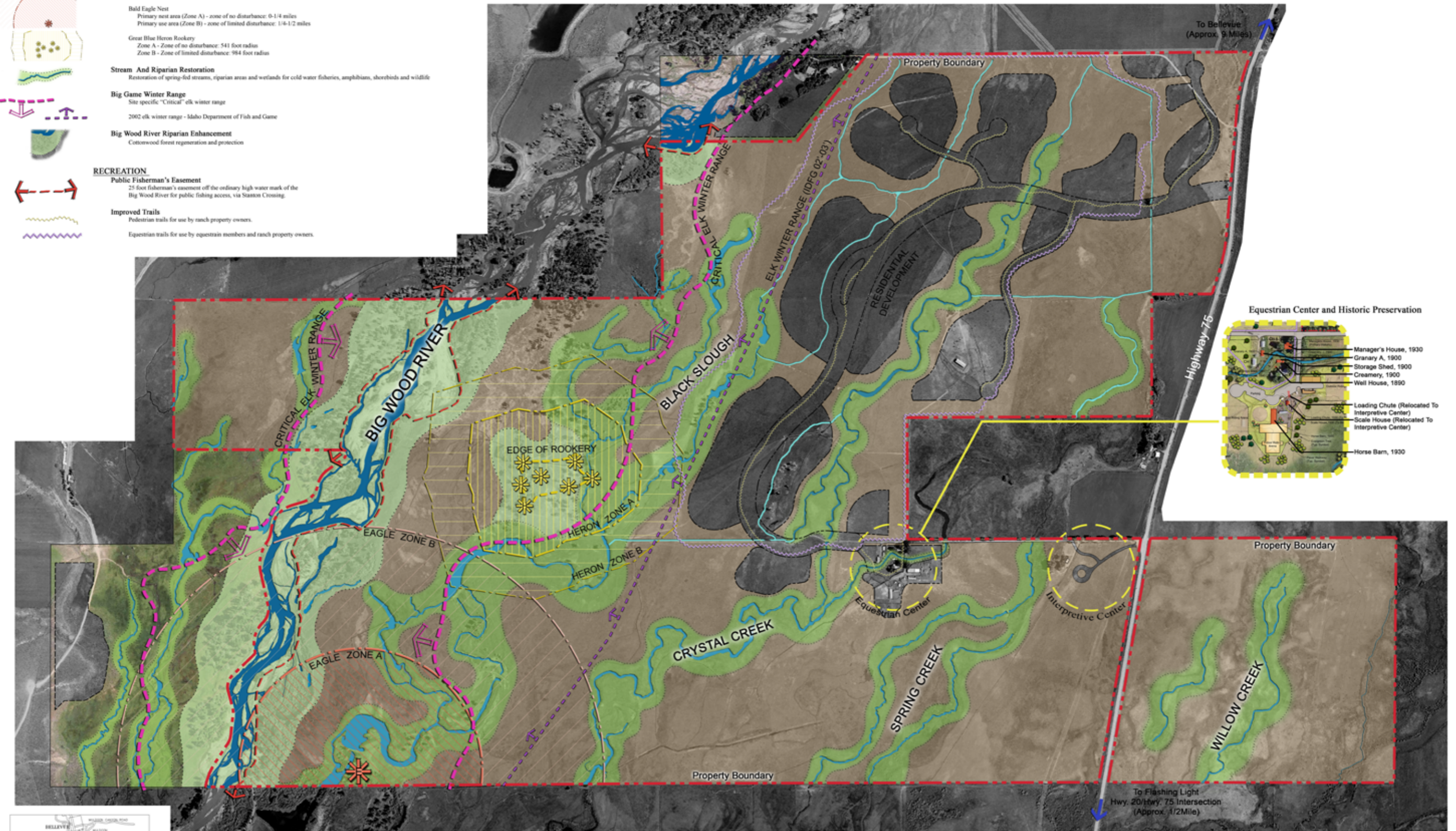

# CRYSTAL CREEK RANCH

## PRELIMINARY CONCEPTUAL CONSERVATION PLAN